

Notes:

- o/ A classic Golden Ratio based derivative of the Mar-Ke;70 designed for modified Creative Sound/Mark Audio EL70, will work well with stock driver
- 1/ to be built as mirror imaged pairs – drivers are mounted off-centre (based on the golden ratio)
- 2/ All panels 15mm
- 3/ Vents are 15mm high, vent spacer is 60mm wide and centrally located
- 4/ brace shape is only suggestive – prime purpose is to brace driver, it needs to be about 35-40% holes. (ie if you have to mount a terminal cup in the middle, you'll want to make sure the brace allows clearance), It is centrally mounted on the driver magnet
- 5/ Don't forget to angle cut the back of the driver cut-out to give it breathing room
- 6/ All internal panels lined with ~1/2" (12mm) cotton or wool felt (preferred), 3/4" (19mm) poly-fluff batting, or 1" (25mm) fiberglass Note that it is hard to get into the box after it is sealed up (means terminals need to be solderable from outside the box as well)



Classic GR Mar-Kel70 ov91

CSS EL70 | 15mm

© 2011-2012 planet_10 enterprises limited
 18- february-2012| designed & drawn by dld
 free for non-commercial use only

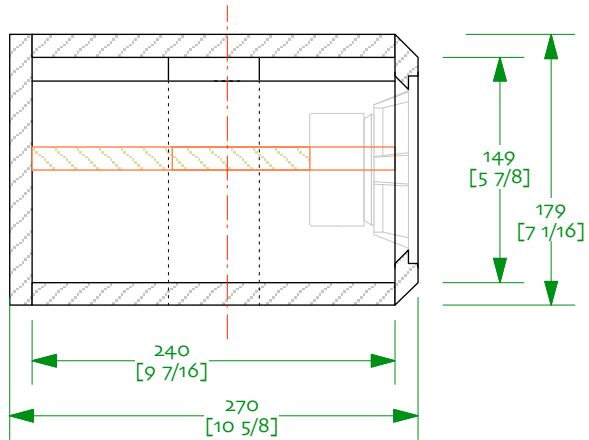

Notes:

- 0/ A classic Golden Ratio based derivative of the Mar-Kel70 designed for modified Creative Sound/Mark Audio EL70, will work well with stock driver
- 1/ to be built as mirror imaged pairs – drivers are mounted off-centre (based on the golden ratio)
- 2/ All panels 15mm
- 3/ Vents are 15mm high, vent spacer is 60mm wide and centrally located
- 4/ brace shape is only suggestive – prime purpose is to brace driver, it needs to be about 35-40% holes. (ie if you have to mount a terminal cup in the middle, you'll want to make sure the brace allows clearance), It is centrally mounted on the driver magnet
- 5/ Don't forget to angle cut the back of the driver cut-out to give it breathing room
- 6/ All internal panels lined with ~1/2" (12mm) cotton or wool felt (preferred), 3/4" (19mm) poly-fluff batting, or 1" (25mm) fiberglass Note that it is hard to get into the box after it is sealed up (means terminals need to be solderable from outside the box as well)



Classic GR Mar-Kel70 ov91

Narrow | CSS EL70 | 15mm
 © 2011-2012 planet_10 enterprises limited
 18- february-2012| designed & drawn by dld
 free for non-commercial use only

